

MAGNAVOX

AIR CONDITIONER REMOTE CONTROL MANUAL



MODEL: W-08CR
W-10CR
W-12CR

MAGNAVOX and SMART. VERY SMART are registered trademarks of Koninklijke Philips N.V. and are used under license from Koninklijke Philips N.V.

Thank you very much for purchasing our air conditioner. Please read this owner's manual carefully before using your air conditioner.

CONTENTS

Using the remote control	2
Remote control specifications	3
Buttons functions	4
How to use the buttons	5
Auto mode	5
Cooling/Heating/Fan mode	5
Dehumidifying mode	6
Sleep mode	6
Timer	7

Using the remote control

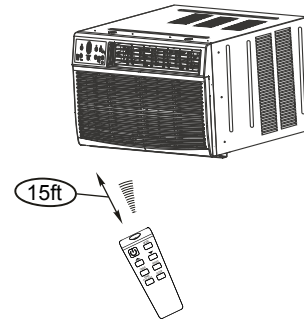

Range of the remote control

- Use the remote control within a 15 foot range from the appliance, pointing it towards the receiver. Reception is confirmed by a beep.

CAUTIONS

- The air conditioner will not operate if curtains, doors or other materials block the signals from the remote control to the AC unit.
- Prevent any liquid from going into the remote control. Do not expose the remote control to direct sunlight or heat.
- If the infrared signal receiver on the AC unit is exposed to direct sunlight, the air conditioner may not function properly. Use curtains to prevent the sunlight from interfering with the receiver.
- If other electrical appliances react to the remote control, either move these appliances or consult your local dealer.

Replacing batteries

The remote control is powered by two AAA batteries located in the back cover.

- (1) Remove the cover by pressing in and sliding back.
- (2) Remove the old batteries and insert the new batteries, placing the (+) and (-) ends correctly.
- (3) Reattach the cover by sliding it back into position.

NOTE: When the batteries are removed, the remote control resets all user configured programming. After inserting new batteries, the remote control will have to be reprogrammed.

Remote Control Specifications

Remote Control Models	RG32A/E, RG32A/CE
Battery Type	3.0V(Two AAA batteries)
Lowest Voltage of CPU Emitting Signal	2.4V
Signal Receiving Range	15ft
Operating Temperature	-5°C~60°C(23°F~140°F)

Function buttons

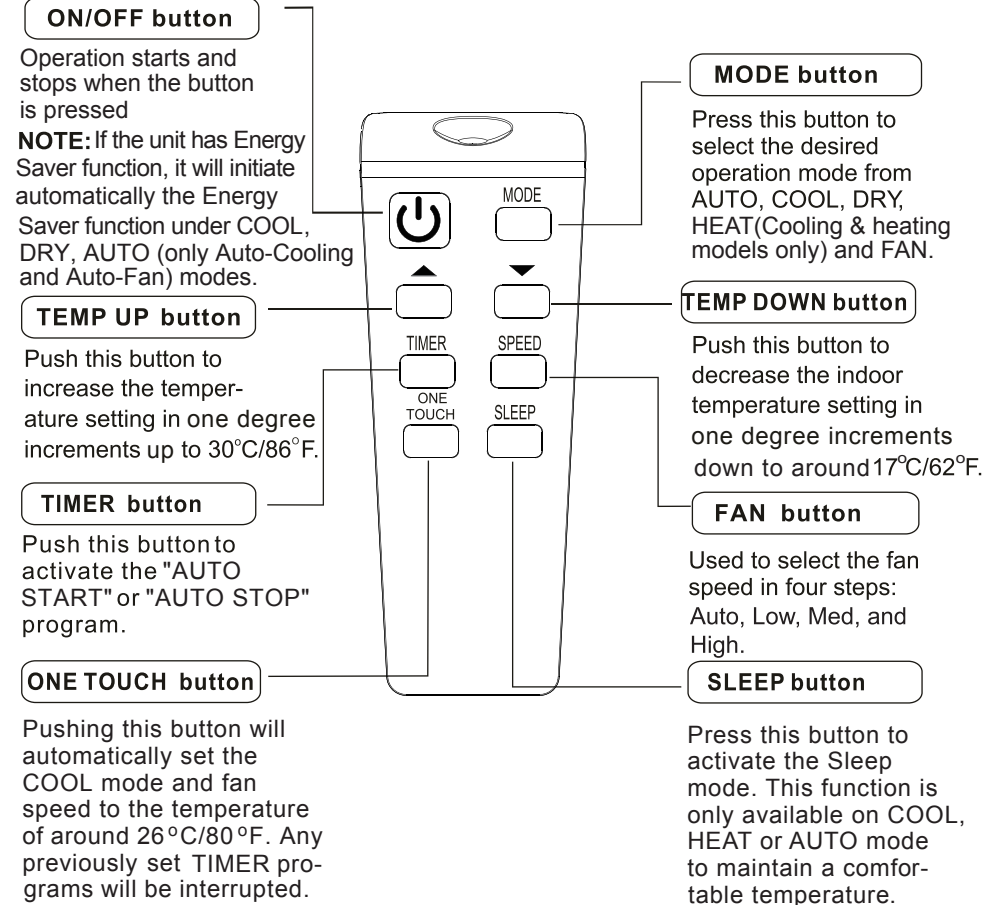

NOTE: All the illustrations are for explanation purposes only. The actual remote control design may differ.

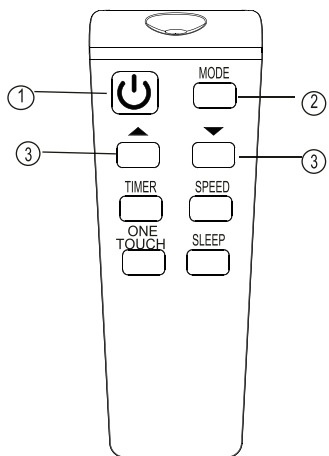

How to use the buttons

Auto mode

Ensure the unit is plugged in and power is running.

1. Press the **ON/OFF** button to start the air conditioner.
2. Press the **MODE** button to select Auto.
3. Press the **TEMP UP/DOWN** button to set the desired temperature. The temperature can be set within a range of 17°C/62°F~30°C/86°F in one degree increments.

NOTE

1. In Auto mode, the air conditioner will automatically select the mode of Cooling, Fan, or Heating depending on the difference between the actual room temperature and the desired set temperature on the remote control.
2. In Auto mode, the fan speed is controlled automatically.
3. If Auto mode is not comfortable for you, change the mode so that it can be selected manually.

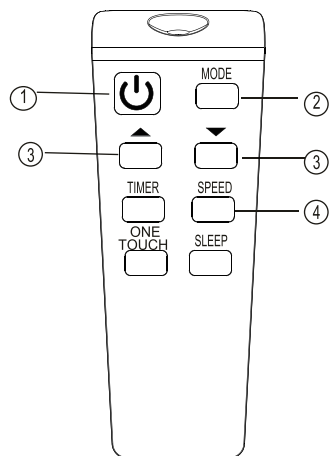

Cooling /Heating/Fan mode

(Heating mode: only on some models)

Ensure the unit is plugged in and power is running.

1. Press the **ON/OFF** button to start the air conditioner.
2. Press the **MODE** button to select Cool, Heat (cooling & heating models only) or Fan mode.
3. Press the **TEMP UP/DOWN** button to set the desired temperature. The temperature can be set within a range of 17°C/62°F~30°C/86°F in one degree increments.
4. Press the **FAN** button to select the fan speed in four steps-Auto, Low, Med, or High.

NOTE

In Fan mode, the setting temperature is not displayed in the remote control and you are not able to control the room temperature either. In this case, only step 1, 2 and 4 may be performed.

5

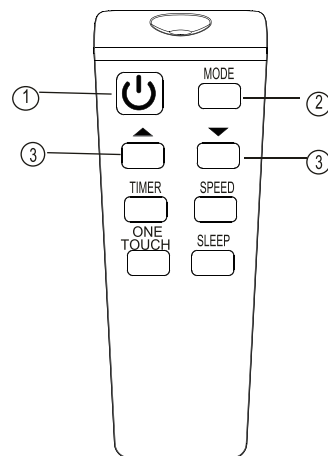

Dehumidifying mode *(only on some models)*

Ensure the unit is plugged in and power is running.

1. Press the **ON/OFF** button to start the air conditioner.
2. Press the **MODE** button to select Dry.
3. Press the **TEMP UP/DOWN** button to set the desired temperature. The temperature can be set within a range of 17°C/62°F~30°C/86°F in one degree increments.

NOTE

In the Dehumidifying mode, you cannot switch the fan speed. It is automatically controlled in this mode.

SLEEP mode *(only on some models)*

- Press this button to activate the Sleep mode. This function is available on COOL, HEAT or AUTO mode only to maintain the most comfortable temperature for you.
- In this mode, the selected temperature will increase by one degree, 30 minutes after the mode is selected. The temperature will then increase by another one degree after an additional 30 minutes. This new temperature will be maintained for 6 hours before it returns to the originally selected temperature. This ends the Sleep mode and the unit will continue to operate as originally programmed.
- The Sleep mode program can be cancelled when the MODE, ON/OFF, FAN SPEED and SLEEP button is pressed during operation.

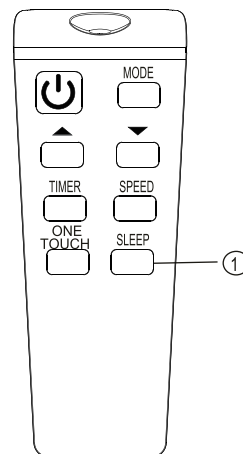

6

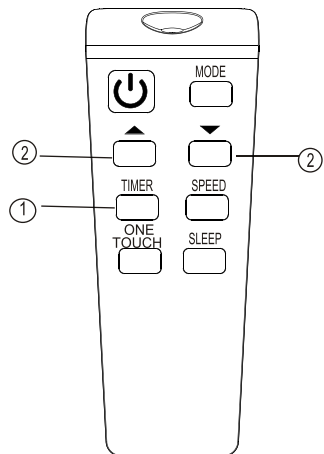

Timer operation

Press the TIMER button to initiate the AUTO-START and AUTO-STOP setting program of the unit. The time can be set in the range of 0~24 hours.

To set the AUTO-START/STOP time.

1. Press the TIMER button, the TIMER ON indicator is shown on the LED display of the air conditioner, it indicates that the AUTO-START setting program is initiated. When the TIMER OFF indicator is displayed on the LED display of the air conditioner it indicates that the AUTO-STOP setting program is initiated.
2. Press or hold the UP(▲) or DOWN(▼)button to change the Auto time by 30 minute increments, up to 10 hours, then at 1 hour increments up to 24 hours. The control will count down the time remaining until start/stop.
3. The selected time will register in 5 seconds and the air conditioner will automatically revert back to display the previous temperature setting.
4. Turning the unit ON or OFF at any time will cancel the AUTO START/STOP function.

NOTE: To cancel the TIMER setting, push the TIMER button and press or hold the UP (▲) or DOWN (▼) until 0 hour is displayed on the LCD display of the air conditioner.

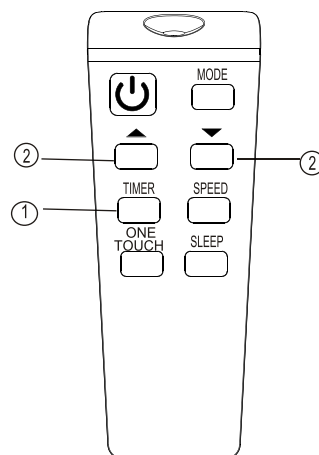

COMBINED TIMER

(Setting both ON and OFF timers simultaneously)

AUTO STOP → AUTO START (On → Stop → Start operation)

This feature is useful when you want to program the AC to automatically STOP and then START.

Example:

To stop the air conditioner 2 hours after setting and start it again 10 hours after setting.

1. Press the TIMER button until the TIMER OFF indicator is displayed on the LED display of the air conditioner.
2. Use the UP/DOWN button to display "2.0" on the LED display of the air conditioner.
3. Press the TIMER button again to display the TIMER ON on the LED display of the unit.
4. Use the UP/DOWN button to display "10" on the LED display of the unit.
5. Wait for 5 seconds until the previous display revert back to the LED window.

AUTO START→ AUTO STOP (Off → Start → Stop operation)

This feature is useful when you want to program the AC to automatically START and then STOP.

Example:

To start the air conditioner 5 hours after setting, and stop it 8 hours after setting.

1. Press the TIMER button until the TIMER ON indicator appears on the LED display of the air conditioner.
2. Use the UP/DOWN button to display "5.0" on the LED display of the air conditioner.
3. Press the TIMER button again to display the TIMER OFF on the LED display of the unit.
4. Use the UP/DOWN button to display "8.0" on the LED display of the unit.
5. Wait for 5 seconds until the previous display revert back to the LED window.